

For Lease

819 N 10th St | Sacramento, CA 95811



PROPERTY HIGHLIGHTS

- ±89,500 SF total available
- Existing office
- 16'-24' clear height
- 16 dock loading doors
- 3 grade level doors
- Warehouse insulated
- Skylights
- Downtown Sacramento River District
- Fenced enclosed yard
- T8-lighting throughout warehouse area
- 800amps of 277/480

Mike Zimmerman, SIOR
Managing Director
RE License # 01514055
T +1 916 491 4312
mike.zimmerman@am.jll.com

Sean Merold, SIOR
Managing Director
RE License # 01803204
T +1 916 491 4313
sean.merold@am.jll.com

Mike Metzger
Executive Vice President
RE License # 01902110
T +1 916 440 1830
mike.metzger@am.jll.com



FLOOR PLAN

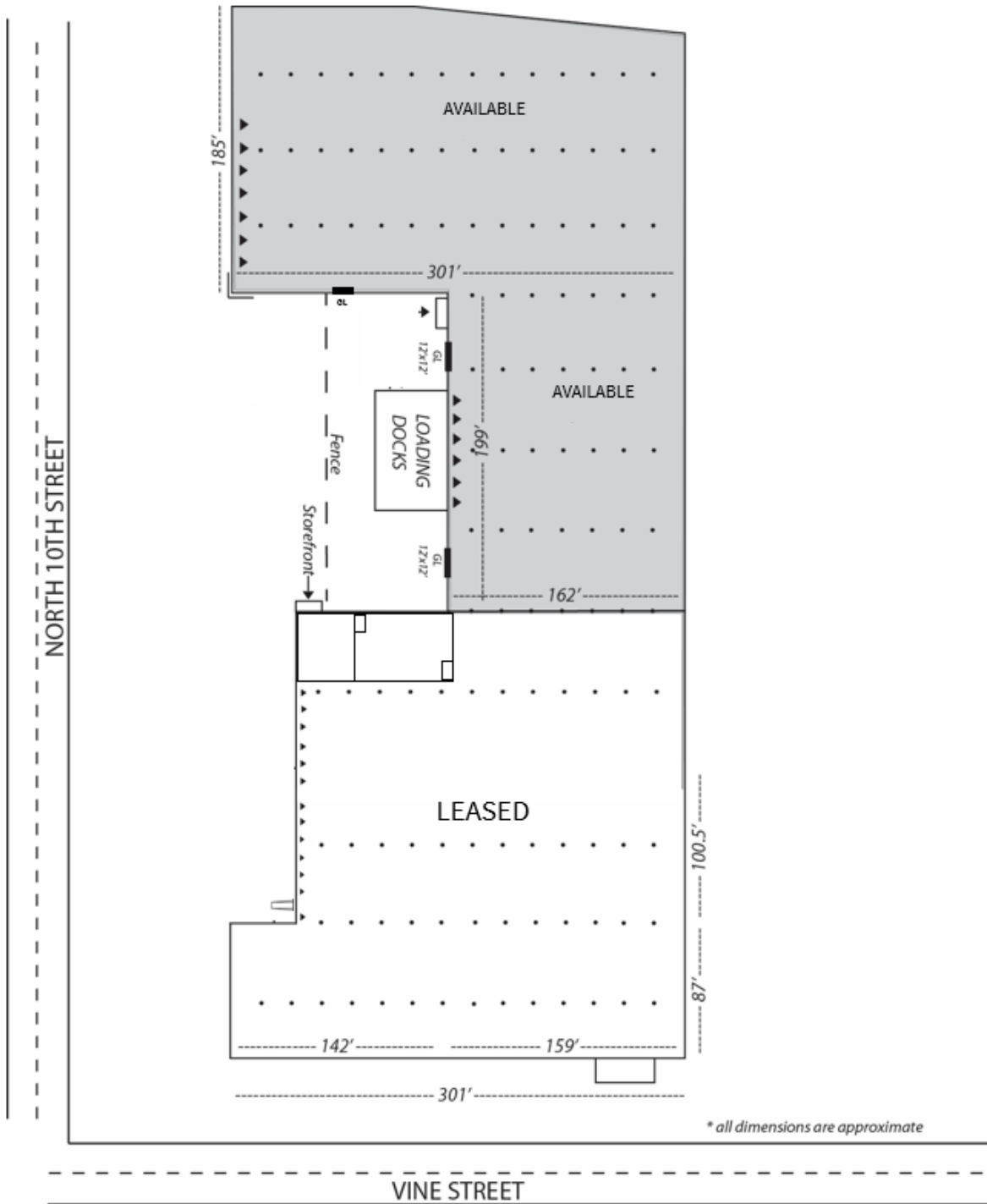

Mike Zimmerman, SIOR
Managing Director
RE License # 01514055
T +1 916 491 4312
mike.zimmerman@am.jll.com

Sean Merold, SIOR
Managing Director
RE License # 01803204
T +1 916 491 4313
sean.merold@am.jll.com

Mike Metzger
Executive Vice President
RE License # 01902110
T +1 916 440 1830
mike.metzger@am.jll.com



For Lease

819 N 10th St | Sacramento, CA 95811



Mike Zimmerman, SIOR
Managing Director
RE License # 01514055
T +1 916 491 4312
mike.zimmerman@am.jll.com

Sean Merold, SIOR
Managing Director
RE License # 01803204
T +1 916 491 4313
sean.merold@am.jll.com

Mike Metzger
Executive Vice President
RE License # 01902110
T +1 916 440 1830
mike.metzger@am.jll.com

